

## Hydra Bed Arm Cylinder Length Adjustment

The Hydra Bed arms are powered AND synchronized by a rephasing pair of hydraulic cylinders. The passenger arm cylinder of that pair is equipped with a threaded rod/clevis arrangement. This feature provides a means of adjusting the passenger arm position in relation to the driver's arm position. During the initial installation of the bed, adjustment of the passenger arm cylinder length may be necessary for accurate synchronization which is defined as both arms contacting the sides of the bed at the same time.

Proper cylinder length adjustment steps are:

1. Make certain ALL air is purged from both arm cylinders.
  - a. DO NOT disconnect or loosen any hydraulic fittings! The Hydra Bed cylinders are self-purging.
  - b. With the pump engaged and the arms in their fully rearward position (fully upward on all 7' wide models ending in "00" and "05"), activate and hold the GRIP function for 30 seconds. This allows both arm cylinders to fully extend.
  - c. At this fully extended (arms fully gripped) position, the cylinder rephasing function is enabled and any trapped air is purged by the hydraulic flow moving through the circuit.
2. Activate the LOAD control to bring the arms within 1 inch of the stowed (home) position.
3. Activate the GRIP control until an arm just touches the bed side.
4. If both arms are touching the bed side evenly, no adjustment is necessary.
5. If only the Driver's arm is touching, measure and record the gap between the Passenger arm and bed side, proceed to **Step 7**.
6. If only the Passenger arm is touching, measure and record the gap between the Driver's arm and bed side, proceed to **Step 10**.
7. **START HERE IF DRIVER'S ARM IS TOUCHING BEFORE PASSENGER ARM:** After moving the arms to a rearward position, activate the RELEASE control until the passenger cylinder clevis locknut is Accessible. Turn system OFF.

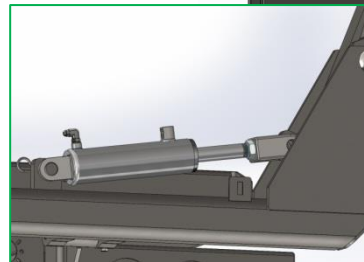
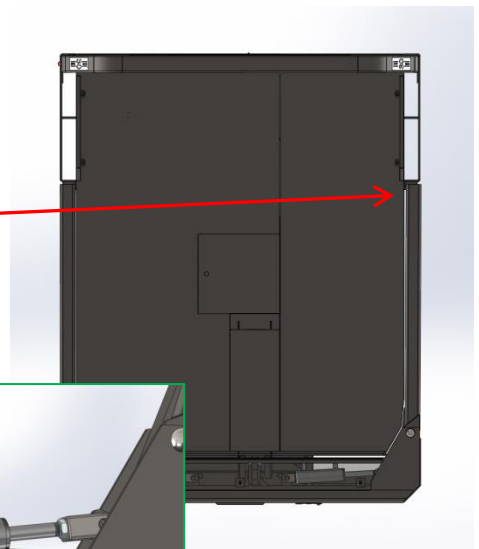
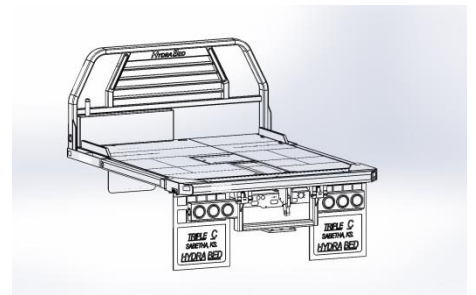
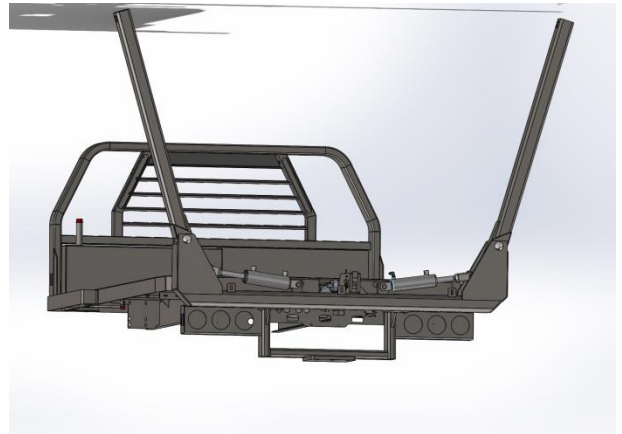

8. Using a 1-5/8" open end wrench, loosen the locknut.
9. Using a 1" open end wrench, turn the passenger cylinder shaft OUT of the clevis (top of shaft will rotate TOWARD the bed). One full revolution of the shaft will move the passenger arm tip toward the bed side approximately 1/2".

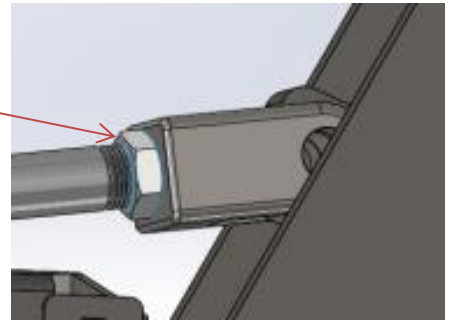

10. **START HERE IF PASSENGER ARM IS TOUCHING BEFORE DRIVER'S ARM:** After moving the arms to a rearward position, activate the RELEASE control until the passenger cylinder clevis locknut is accessible. Turn system OFF.
11. Using a 1-5/8" open end wrench, loosen the locknut.
12. Using a 1" open end wrench, turn the passenger cylinder shaft IN to the clevis (top of shaft will rotate AWAY from the bed). One full revolution of the shaft will move the passenger arm tip away from the bed side approximately 1/2".
13. Re-tighten the clevis lock nut.
14. Re-check for accurate synchronization and repeat above steps as necessary.